



# TEXAS EQUIPMENT

## 2 Post Asymmetric Hydraulic Lift PARTS CATALOG

### United States

17779 Main Street Suite C  
Irvine, CA 92614 USA  
Tel: +1(949) 333-3800  
Fax: +1(949) 333-3804

### United Arab Emirates

P.O. Box 121971 Saif Zone A2-032  
Sharjah, UAE  
Tel: +971 (06) 552 98 60  
Fax: +971 (06) 552 98 61

### Egypt

9A Al-Mothalath  
End of Mostafa El-Nahas Street  
Nasr City, Cairo 11528 Egypt  
Tel: +2019 550 0001  
Fax: +2022 472 4346



# Exploded Diagram

## 27010H

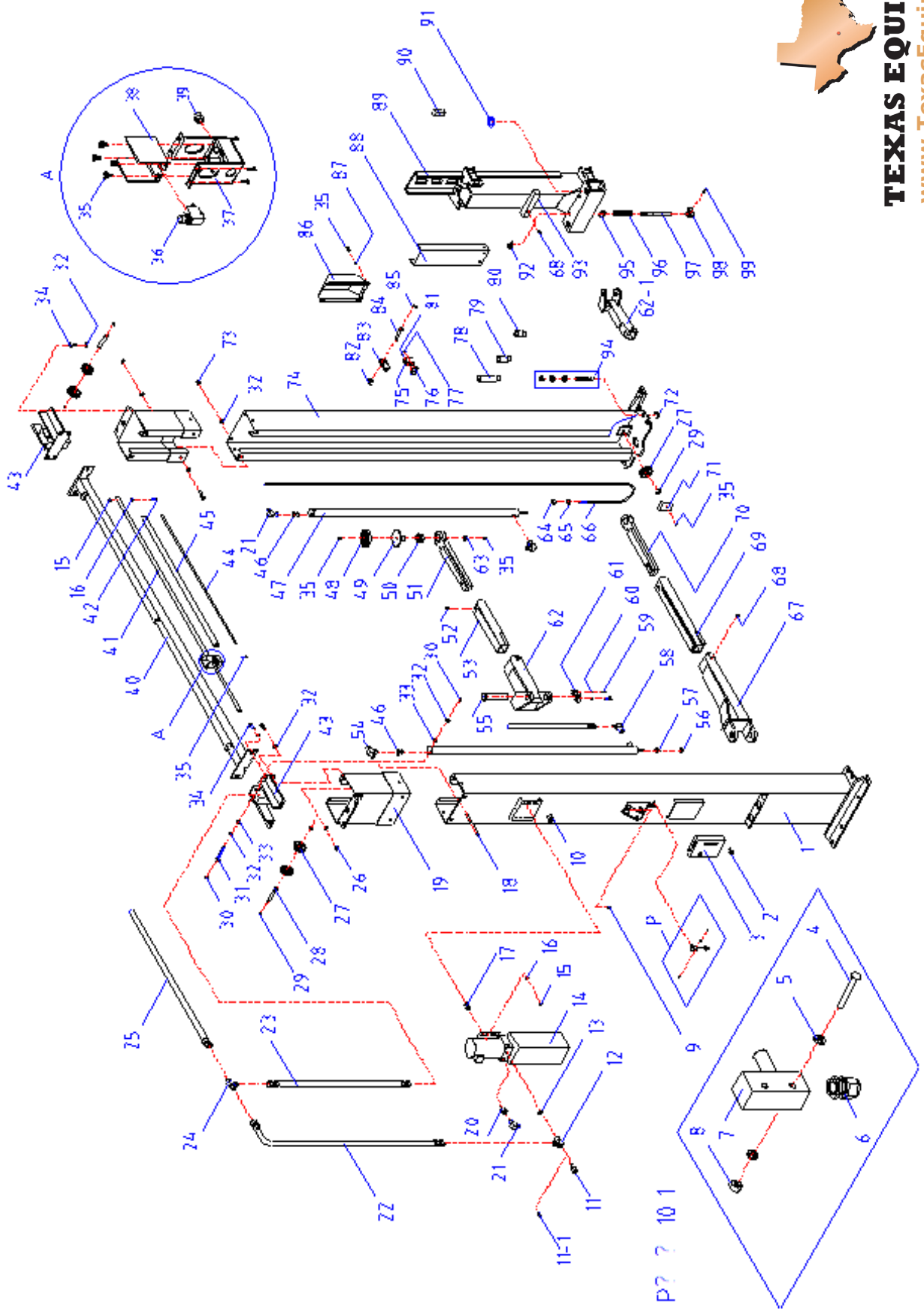

<b>ITEM</b>	<b>CODE</b>	<b>DESCRIPTION</b>	<b>QTY</b>
1	165948 *01-001	Column jointings	1
2	165948 *01-002	Screw	4
3	165948 *01-003	Box	1
4	165948 *01-004	Screw	2
5	165948 *01-005	Washer	4
6	165948 *01-006	Cap	1
7	165948 *01-007	Switch	1
8	165948 *01-008	Nut	2
9	165948 *01-009	Damper	2
10	165948 *01-010	Magnet	1
11	165948 *01-011	Fitting	1
11—1	165948 *01-011-1	Plug	1
12	165948 *01-012	T fitting	1
13	165948 *01-013	O-Ring	1
14	165948 *01-014	Pump	1
15	165948 *01-015	Nut	9
16	165948 *01-016	Flat washer	9
17	165948 *01-017	Damp washer	4
18	165948 *01-018	Air tube	1
19	165948 *01-019	Vice column jointings	2
20	165948 *01-020	Fitting	1
21	165948 *01-021	Elbow fitting	2
22	165948 *01-022	Oil pipe	1
23	165948 *01-023	Oil pipe	1
24	165948 *01-024	T fitting	1
25	165948 *01-025	Oil pipe	1
26	165948 *01-026	Nut	12
27	165948 *01-027	Pulley	6
28	165948 *01-028	Spindle	2
29	165948 *01-029	Washer	6
30	165948 *01-030	Washer	4

<b>ITEM</b>	<b>CODE</b>	<b>DESCRIPTION</b>	<b>QTY</b>
31	165948 *01-031	Pin	2
32	165948 *01-032	Flat washer	52
33	165948 *01-033	Sheath	4
34	165948 *01-034	Haxangular bolt	24
35	165948 *01-035	bolt	34
36	165948 *01-036	Switch	1
37	165948 *01-037	Switch cover	1
38	165948 *01-038	Plate	1
39	165948 *01-039	Cap	1
40	165948 *01-040	Cross beam parts	1
41	165948 *01-041	Pole	1
42	165948 *01-042	Haxangular bolt	1
43	165948 *01-043	Link arm	2
44	165948 *01-044	Air tube	1
45	165948 *01-045	Sponge bush	1
46	165948 *01-046	Fitting	2
47	165948 *01-047	Hydraulic cylinder	2
48	165948 *01-048	Rubber washer	4
49	165948 *01-049	Salver jointing	4
50	165948 *01-050	Helicoid	4
51	165948 *01-051	Short salver jointings	2
52	165948 *01-052	Bolt	4
53	165948 *01-053	Flex arm	2
54	165948 *01-054	T fitting	1
55	165948 *01-055	Pin	4
56	165948 *01-056	Nut	2
57	165948 *01-057	Nut	2
58	165948 *01-058	Elbow fitting	2
59	165948 *01-059	Haxangular bolt	8
60	165948 *01-060	Washer	8
61	165948 *01-061	Gear	4
62	165948 *01-062	Swing arms(Left)	1

<b>ITEM</b>	<b>CODE</b>	<b>DESCRIPTION</b>	<b>QTY</b>
62-1	165948 *01-062-1	Swing arms(Right)	1
63	165948 *01-063	Washer	4
64	165948 *01-064	Nut	8
65	165948 *01-065	Flat washer	4
66	165948 *01-066	Safty cable	2
67	165948 *01-067	Swing arms	2
68	165948 *01-068	Bolt	8
69	165948 *01-069	Flex arm	2
70	165948 *01-070	Long salver jointings	2
71	165948 *01-071	Cover	2
72	165948 *01-072	Adjust washer	16
73	165948 *01-073	Self-lock nut	12
74	165948 *01-074	Column jointings	1
75	165948 *01-075	Electromagnet	2
76	165948 *01-076	Plate	2
77	165948 *01-077	Screw	8
78	165948 *01-078	Spindle	4
79	165948 *01-079	Spindle	4
80	165948 *01-080	Spindle	4
81	165948 *01-081	Screw	8
82	165948 *01-082	Case	4
83	165948 *01-083	Roof	2
84	165948 *01-084	Rod	2
85	165948 *01-085	Washer	4
86	165948 *01-086	Cover	2
87	165948 *01-087	Washer	8
88	165948 *01-088	Shild	2
89	165948 *01-089	Carriage	2
90	165948 *01-090	Rubber block	16
91	165948 *01-091	Washer	4
92	165948 *01-092	Washer	4
93	165948 *01-093	Rubber washer	2

<b>ITEM</b>	<b>CODE</b>	<b>DESCRIPTION</b>	<b>QTY</b>
94	165948 *01-094	Upset bolt	12
95	165948 *01-095	Key ring	4
96	165948 *01-096	Spring	4
97	165948 *01-097	Rack spindle	4
98	165948 *01-098	Gear	4
99	165948 *01-099	Pin	4